

GENERAL SPECIFICATIONS

• L.O.A	14,60 m	47'11"
• Hull length	14,27 m	46'10"
• L.W.L.	13,86 m	45'6"
• Beam	4,74 m	15'7"
• Deep draft	2,17 m	7'1"
• Deep ballast weight	3 550 kg	7,826 lbs
• Shallow draft	1,83 m	6'
• Shallow ballast weight	4 060 kg	8,951 lbs
• Air draft	21,69 m	71'2"
• Light displacement	12 594 kg	27,765 lbs
• Fuel capacity (standard)	200 L	53 US Gal
• Fuel capacity (Option)	200 L	53 US Gal
• Fresh water capacity (standard)	370 L	98 US Gal
• Fresh water capacity (Option)	320 L	85 US Gal
• Engine power	80 HP	80 HP

ARCHITECTS / DESIGNERS

- Naval Architect: Berret Racoupeau Yacht Design
- Interior design: Nauta Design

CE CERTIFICATION

- Category A - 11 people
- Category B - 12 people
- Category C - 14 people

STANDARD SAIL LAYOUT AND AREA

• Mainsail	56,00 m ²	603 sq ft
• Genoa (105 %)	56,00 m ²	603 sq ft
• Asymmetrical spinnaker	160,00 m ²	1,722 sq ft
• I	18,75 m	61'6"
• J	6,06 m	19'11"
• P	17,09 m	56'1"
• E	5,55 m	18'3"

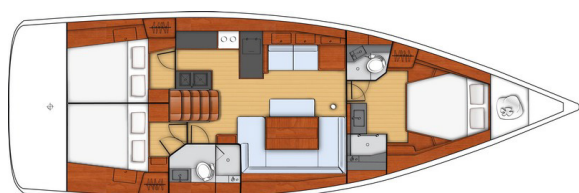
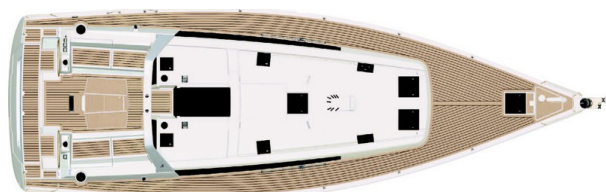

3 cabins - 2 heads

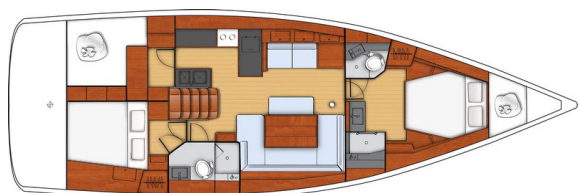

2 cabins - 2 heads





STANDARD EQUIPMENT

CONSTRUCTION

- Design in accordance with European Directive requirements and according to CE certification
- Monolithic hull design in polyester
- Monolithic structural inner moulding bonded to the hull
- Injection moulded deck in glass fiber/balsa sandwich, covered with «diamond-point» non-slip coating
- Deck hull joint screwed, bonded and banded with 1 solid wood bulwark
- Cast iron keel fixed with bolts and stainless steel backing plates
- Rudder hung with glass composite stock
- White coloured hull - Grey metal hull graphics

DECK EQUIPMENT

RIGGING

- Standard mast 9/10 anodized aluminium deck stepped, 2 aft-swept spreaders
- Anodised aluminium boom
- Discontinuous stainless steel standing rigging
- 2 Backstays with bottlescrews
- Rigid boom vang with tackle
- Genoa furling system with drum on the deck
- 2 Stand Up blocks for mainsail on fixed composite arch
- 2 Genoa tracks with piston adjusted traveller cars
- 2 Genoa sheet turning blocks
- Rigging run back to cockpit (except boom topping lift)
- Complete running rigging: Main halyard, genoa halyard with clutch on mast and cleat, Boom topping lift with cleat on mast, Mainsheet, 2 Genoa sheets 2 rapid reefing lines, 1 manual reef
- 8 Clutches
- 2 halyard bags

WINCHES

- 2 Self-tailing genoa sheet winches (H60.2 STC)
- 2 Self tailing coachroof winches (H46.2 STC)
- 2 Aluminium winch handles Speed Grip
- 2 Winch handle boxes

SAILS

- Furling genoa with UV protective strip
- Semi full batten sail with slider and roller slider (with logo)
- System: Lazy Jack and Lazy Bag in Natural colour

MOORING LINES - MOORING

- Self-draining chain locker - Clench bolt - Hatch cover
- Stainless steel bow fitting 2 rollers
- 12 V - 1500 W vertical electrical windlass - Remote control
- 6 Aluminium mooring cleats - Stainless steel chafing plate

SAIL LOCKER

- Access through deck hatch T60
- Stainless steel ladder
- Shelving unit

SAFETY ON DECK

- 1 Open stainless steel pulpit
- 2 Stainless steel pushpits
- 1 Lifebuoys support bracket
- 1 Outboard engine bracket
- Welded ring on pushpit for flag
- Double guard lines and stainless steel stanchions - Side boarding gate on either side

COCKPIT

- Self-draining cockpit
- 2 Cockpit locker
- 2 Lockers in cockpit sole beneath helm's feet
- 1 Liferaft locker under helm seat (0,80 m x 0,40 m x 0,58 m / 2'7" x 1'4" x 1'4")
- 1 Gas locker for bottle(s) under the port helm seat
- Natural solid wood slatted cockpit benches
- 2 Steering wheel consoles: Stainless steel steering wheels - 900 mm diameter - Leather covered - Steering gear at the helm station - metal cable transmission system - Stainless steel handrail - navigation instrument support (optional instruments) - Cup holder
- 1 Deck filler for access to tiller system + Power supply access hatch
- 1 Tiller
- 2 Steering compass on binacelle
- Portside engine control and control panel
- Polyester cockpit table - 2 Leaves - miscellaneous locker - 2 Large storage space - Stainless steel handrail - 12 V socket - lamp with shade
- Cold water cockpit shower hose
- 1 Fixed composite arch - Integrated lights
- 1 Shore power socket to port
- 2 Hinged PMMA companionway doors - Sliding hatch made of PMMA

SWIM PLATFORM / STERN DECK

- Fully opening transom, convertible to bathing platform (2,85 m x 0,77 m / 9'4" x 2'6")
- Electrically operated
- Natural solid wood decking on swim platform
- 1 Stainless steel swim/boarding ladder - solid wood steps - folding

INTERIOR

- Alpi Moabi interior wood
- Parquet type laminated floors
- Fabric hull linings in saloon and cabins (White)
- Fabric upholstery
- Marine mattresses in the cabins

COMPANIONWAY

- Headroom: 1,98 m / 6'6"
- Wooden saloon companionway with moulded wood suspended steps with non-slip surface
- 2 Leather covered stainless steel handrails

SALOON

- Headroom: 1,98 m / 6'6"
- U shaped saloon bench - double density foam
- Seating on pantograph
- Saloon table in 1 piece - Varnished wood top with inlay - Aluminium legs
- Mirror on bulkhead
- Cupboards - Shelves and stowage along the hull - Storage under bench seats
- Shelves with stainless steel fiddles
- 2 Panoramic deck house windows with concertina blinds
- 2 Hull portholes with curtain
- 2 Opening portholes on coaming in side windows
- 1 Opening deck hatch with mosquito blind

CHART TABLE - PORT SIDE

- Sliding, can be configured with the armchairs - Placed against the forward bulkhead, against the galley or between the 2 mobile seats
- Table with flap - Moulded wood fiddle
- Switch panel on bulkhead for access to electrical functions
- Navigation instrument panel (without instruments)
- 1 Reading light



GALLEY - PORT SIDE

- Headroom: 1,90 m / 6'3"
- L-shaped galley with separate sink located below companionway
- Compact grey laminated worktop
- 1 Stainless steel sink 2 rectangular basins - 1 Mixer tap with hot/cold water under pressure
- 1 Gas cooker 2 burners - Stainless steel oven on gimbal - Stainless steel protection handrail
- 1 100L / 26 US Gal icebox (12V), top opening
- 1 130 L / 34 US Gal refrigerator (12V), front opening
- Fitted lockers and closed shelving (Shelving, Bin)
- 1 Lower unit: 1 Drawer - 2 shelves
- Storage space along the hull
- 2 Opening ports on coaming with curtains on side windows

FORWARD CABIN

- Headroom: 1,92 m / 6'4"
- Central double bed (2,09 m x 1,55 m x 1,18 m / 6'10" x 5'1" x 3'10")
- Hanger closets - Valet tray - Cubby hole locker - Lower unit - Storage space under bed
- 2 Flush deck hatches with mosquito blind
- 2 Hull portholes with curtain

FORWARD HEAD

Completely built in to the cabin with:

TO STARBOARD

- Moulded basin in grey work surface, Hot/cold water mixer tap
- 1 Washroom storage cabinet
- 1 Mirror
- 1 Glass shower cabin with flush access and stowage on the bulkhead
- 1 Deck hatch with mosquito blind

TO PORT

- Separate WC
- 1 64 L / 17 US Gal rigid holding tank
- Hand basin
- Storage space along the hull
- 1 Deck hatch with mosquito blind

STARBOARD AFT HEAD COMPARTMENT

- Headroom: 1,92 m / 6'4"
- Access from the saloon or the starboard aft cabin
- Separate shower - 1 Hot/cold water mixer tap - Stowage on bulkhead
- 1 Manual toilet
- 1 64 L / 17 US Gal rigid holding tank
- Washbasin - 1 Hot/cold water mixer tap
- 2 Mirrors
- Toilet accessories
- 1 Opening portlight with curtains in the coachroof side window

STARBOARD AFT CABIN

- Headroom: 1,86 m / 6'1"
- 1 Double bed (2,09 m x 1,18 m x 1,55 m / 6'10" x 3'10" x 5'1")
- Access door to starboard aft head
- Cupboards, Hanging locker, Closed shelving, Stowage on both sides of berth
- 1 Large size hull port with curtain
- 1 Opening deck hatch with mosquito blind
- 1 Opening cockpit port with curtain
- 1 Glazing on companionway bulkhead

2 cabins layout, 2 heads

AFT-GALLEY - PORT SIDE

- Headroom: 1,90 m / 6'3"
- Closed galley aft, accessible through galley
- Cupboards, shelves
- Dedicated position for a 5 kg washer drier (option)
- 1 Opening deck hatch with mosquito blind
- Direct access to cockpit locker (Port side)

3 cabins layout, 2 heads

PORT AFT CABIN

- Headroom: 1,86 m / 6'1"
- 1 Double bed (2,05 m x 1,35 m x 1,55 m / 6'9" x 4'5" x 5'1")
- Cupboards, Hanging locker, Closed shelving
- 1 Large size hull port with curtain
- 1 Opening deck hatch with mosquito blind
- 1 Opening cockpit port with curtain
- 1 Glazing on companionway bulkhead

ENGINE

- Engine Yanmar Diesel:
 - 80 HP / 80 HP Common Rail, Sail Drive (standard)
 - 80 HP / 80 HP Common Rail, Dock & Go (Option)
- Engine control - Control panel in the port cockpit
- Engine compartment: Soundproofing foam - Ventilation: 1 air intake and 1 pressured air outlet
- 1 Alternator 12 V / 125 Ah
- 1 Rotomoulded diesel tank 200 L / 53 US Gal (under port aft berth) - Electronic gauge - Low level alarm - 1 Deck filler
- Filters: Sea water - Diesel - Water separator
- Fixed three blades propeller
- 1 Engine access through companionway (opening with 2 gas struts) - 2 Engine access through aft cabins

ELECTRICITY

- 12 V circuit
- 2 service batteries (140 Ah) - 1 Engine battery (110 Ah)
- 1 Power distributor
- 12 V Electrical panel (Fuses - Voltmeter - Water gauge - Fuel gauge - Battery warning - Fuel warning - Water warning)
- 1 12 V Sockets
- Lighting: Overhead lights - Reading lights - White striplighting
- Navigation lights: 1 Forward and aft navigation lights - 1 Steaming light - 1 Anchor light on masthead
- Wire runs for option cables
- Full 220 V system (Interior sockets 220 V, 40 Amperes battery charger, Shore power socket)

PLUMBING

- 1 Rotomoulded freshwater tank 330 L / 87 US Gal (Forward cabin) - 2 Deck fillers - Separate tank filling - Tank selection with "¼ turn" by-pass valves
- Pressurised electric water pump - Expansion tank - Inline filter
- 40 L / 11 US Gal Electric water heater (engine use)
- 1 Rigid 64 L / 17 US Gal black water holding tank for each WC
- Delayed shower draining and electric shower drain pumps
- 1 Electric bilge pump - 1 Manual bilge pump
- 1 Electric pump for the ice box drain

GAS

- 1 Gas bottle box in the cockpit (Diameter 0,34 m x 0,53 m / 1'1" x 1'9")
- Regulator and safety tap



TRIM LEVEL

	ESSENTIAL	EXCLUSIVE
• B&G Electronic: Helm consoles to port and starboard - 1 Triton 2 display	■	■
• B&G Electronic: Sensor (Log, Speedometer, Temperature)	■	■
• B&G Electronic: Wind Sensor (Windvane, Anemometer)	■	■
• Hot/cold water cockpit shower	■	■
• Hifi: Fusion + Interior loudspeakers & Waterproof exterior speakers	■	■
• LED interior lights	■	■
• 2 Additional 140 ampères service batteries + 1 40 Amperes battery charger additional	■	■
• 1 Port electric primary winch - H46.2 STAECH		■
• Galley: Refrigeration system, 12 V, in top-opening icebox (for storage below 0°C)		■
• Storage space(s) under the floor		■
• Saloon and Cabins: Indirect lighting LED		■
• Stainless steel beading for fenders in cockpit locker		■
• LED: Navigation lights		■

PACKS

ELECTRONIC B&G PACK

A Pack

- Steering consoles (Port and starboard):
 - Multifunction touchscreen Zeus 7" wide wireless (GPS, Chart plotter, Chart reader - Navionics Silver cartography included)

B Pack

- Swivel base on reverse side of cockpit table
- Multifunction touchscreen B&G Zeus 12" wide wireless (GPS, Chart plotter, Chart reader - Navionics Silver cartography included)

PERFORMANCE PACK

- Performance Incidence Sails (D4)
- German system (Two-way mainsheet at the helm station)

VERSION

DOCK & GO

• Engine: YANMAR - Common Rail - Diesel	■
• Swiveling Sail Drive base	■
• Joystick	■
• Vessel Management Unit (VMU)	■
• Bow thruster	■
• Auto pilot	■



OPTIONS

Navigation electronics: B&G

- 4G Radar
- NAC3 autopilot + Control at steering station
- Chart table: Zeus 7" wide additional multifonction screen
- Chart table: Fixed B&G+V50 VHF, AIS receiver function + H50 cockpit handset
- WR 10 Wireless autopilot remote control
- AIS 500
- Forward Scan Sensor (Forward underwater vision)

Rigging - Sails

- Anodized mast furling system with Dacron mainsail
- Asymmetrical spinnaker rigging + Code 0 rigging
- Self-tacking jib hardware
- Asymmetrical spinnaker
- Code 0 with "Top Down" furling system
- Self-tacking jib (replacing genoa)
- Self-tacking staysail with manual furling + Fixed forestay
- Releasable forestay chainplate
- Backstays with bottlescrews (Adjustable)*
- Genoa sheet track leads adjustable from the cockpit
- 2 flag halyards

* Except on mast with in-mast furling

Winches

- 2 Electric genoa winches H 60.2 STCEH

Hull - Deck - Cockpit

- Grey "Perle" hull
- Blue-grey hull
- Cockpit sole natural solid wood
- Slatted solid wood side decks
- Polyester/wood cockpit table + White PVC protective covers
- Silver Coachroof sprayhood
- Silver Cockpit Bimini
- Luxe coachroof sprayhood , Cadet Grey
- Luxe bimini, Cadet Grey
- Complete Luxe cockpit closing, Cadet Grey
- White PVC steering wheel covers
- Covers pack Luxe (Table + Steering consoles), Cadet Grey
- Natte Dusk Cockpit cushions + Carbon Sky backrests
- Bow thruster
- Refrigerated ice-box in cockpit table (30 L / 8 US Gal) - Positive cold
- 3 folding blades propeller
- Stainless steel arch with davits
- White or black composite steering wheels
- Moorings lines, Mooring, Fenders
- Mooring cleats (stern deck)
- Windlass control in cockpit with chain counter
- 4 Underwater lights
- Shore freshwater supply
- Windex Windvane



BENETEAU

Oceanis 48

General Equipment list - Europe

Interior equipment

- Interior woodwork: Alpi satin light oak
 - Luxe folding saloon table (double berth compatible)
 - Interior upholstery, according to swatches: Fabrics, Leather, Ultraleather
 - Upholstery padding (Saloon and Cabins): Anthracite Grey or Taupe
 - TV LED 22" + DVD player in the saloon
 - Stainless steel cooker 3 burner oven/grill on gimbal
 - 220V Microwave oven
 - Dishwasher
 - Sandblasted finish shower screen, Forward cabin (in lieu of standard)
 - Double berth in saloon
 - Slat mattresses
 - Quiet Flush electric toilet
 - Mosquito nets
 - Galley: Sea water/fresh water foot pump
 - Extra water tank (2 x 160 L / 2 x 42 US Gal)
 - Additional diesel tank (200 L / 2 x 53 US Gal)
-
- 12/220 V, 2 kVA inverter
 - 6 KVA 220 V / 50 Hz Generator - with cocoon
 - Forced air heating fuel
 - 220 V / 50 Hz Air conditioning
 - Water maker 60 L / 16 US Gal/h)