

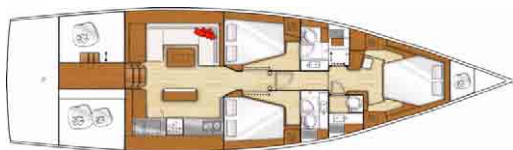

3 cabins - 3 head compartments



3 cabins - 3 head compartments - 1 Occasional cabin (optional)



GENERAL SPECIFICATIONS

• L.O.A	17,20 m	56'5"
• Hull length	16,80 m	55'1"
• L.W.L.	15,93 m	52'3"
• Beam	4,97 m	16'4"
• Deep draught	2,40 m	7'10"
• Deep ballast weight	4 900 kg	10,803 lbs
• Shallow draught	1,85 m	6'1"
• Shallow ballast weight	5 500 kg	12,125 lbs
• Air draught	23,91 m	78'5"
• Light displacement (EC)	18 560 kg	40,918 lbs
• Fuel capacity (standard)	415 l	110 US Gal
• Fuel capacity (Optional equipment)	415 l	110 US Gal
• Fresh water capacity (standard)	640 l	169 US Gal
• Fresh water capacity (Optional equipment)	330 l	87 US Gal
• Engine power	POD 120	POD 120

ARCHITECT / DESIGNERS

- Naval Architect : Berret Racoupeau Yacht Design
- Interior design : Nauta Design

EC CERTIFICATE

- Category A - 10 persons
- Category B - 11 persons
- Category C - 16 persons

STANDARD SAIL LAYOUT AND AREA

• Mainsail (classic)	74 m ²	796 sq ft
• Genoa (105 %)	78,5 m ²	845 sq ft
• Asymmetrical spinnaker	208,3 m ²	2,242 sq ft
• I	21,25 m	69'9"
• J	7,31 m	24'
• P	20,2 m	66'3"
• E	6,35 m	20'10"



STANDARD EQUIPMENT

CONSTRUCTION

- Design in accordance with European Directive requirements and according to EC certification
- Monolithic hull design in polyester
- Monolithic structural counter moulding laminated and bonded to the hull
- Deck in balsa and glass fibre sandwich covered in "diamond point" type non-slip surface
- Hull/deck joint screwed, bonded and covered with a single solid wood rubbing strake screwed in place
- Cast iron keel bonded and bolted using stainless steel bolts and counter plate
- Twin underhung rudders with stainless steel stock
- White coloured hull - Grey metallic livery

DECK EQUIPMENT

RIGGING

- Standard mast SELDEN 9/10 anodized aluminium installed on the deck, 2 aft-swept spreaders - MDS roller slides
- Anodised aluminium boom
- Discontinuous stainless steel standing rigging
- Backstay: Bridle
- Rigid boom vang with tackle
- Genoa furling system with drum on the deck
- 2 Blocks "STANDUP" on mainsheet arch
- 2 genoa tracks with piston adjusted traveller cars - 2 Genoa sheet return blocks
- Rigging run back to cockpit (except boom topping lift)
- Complete running rigging: Main halyard, genoa halyard with clutch on mast and cleat, Boom topping lift with cleat on mast, Mainsheet, 2 Genoa sheets 2 rapid reefing lines, 1 manual reef
- 12 Jammers, and other control lines
- 2 rope boxes

WINCHES

- 2 Self-tailing genoa sheet winches (H60.2 STC)
- 2 Self tailing coachroof winches (H46.2 STC to starboard, H50.2 STC to port)
- 2 Winch handles SpeedGrip
- 2 Winch handle boxes

SAILS

- Dacron furling genoa
- Full batten dacron mainsail with Beneteau logo
- Lazy Jack and Lazy Bag in Natural colour

MOORING LINES - MOORING

- Self-draining chain locker
- Stainless steel bow fitting 2 rollers - Stainless steel bobstay
- 12 V - 1500 W Vertical electrical windlass - Remote control
- 8 Aluminium mooring cleats - Stainless steel deck line protection

SAIL LOCKER

- Access through deck hatch
- Stainless steel ladder
- Hatch giving access to chain locker

SAFETY ON DECK

- 1 Open stainless steel forward pulpit
- 2 fixed stainless steel pushpits
- Stainless steel backrests fitted to helm seats
- 1 Lifebuoy support bracket
- 1 Outboard engine bracket
- 1 Ensign staff
- Double guardrail and stainless steel stanchions - Opening to port and to starboard in guardrail
- 2 Stainless steel handrails on deck
- 2 Stainless steel handrails on fixed arch

COCKPIT

- Self-draining cockpit
- 1 Port cockpit locker - Access to technical area or Occasional cabin (optional)
- 1 Starboard cockpit locker - Access to technical area
- Gas locker beneath starboard cockpit seat
- Natural solid wood slatted cockpit benches
- 1 Liferaft locker in cockpit sole
- 2 Steering wheel consoles: Stainless steel steering wheels - 900 mm / 2'11" diameter - leather covered - Stainless steel handrail - navigation instrument support (optional instruments) - Glass holder - 2 Steering compass on binacle
- 2 Deck access points to tiller system
- Backrests to helm (Natte Stone)
- 1 Tiller
- Engine throttle and control panel to starboard
- Wooden cockpit table with leaf to starboard which can be transformed into sun-bathing area
- 1 Fixed composite arch
- 2 waterproof loudspeakers on fixed arch
- Cockpit lighting integrated in fixed arch
- 1 Glazed companionway hatch drops into cockpit sole - manually operated
- 2 Fixed windows to the aft of the coachroof

AFT TRANSOM

- Retractable transom to cockpit
- 2 Height-adjustable helmsman's seats
- Natural solid wood decking on sun deck
- 1 Stainless steel bathing ladder - solid wood steps - folds into locker
- 1 Hot and cold cockpit shower
- 1 Shore power socket
- 2 wet lockers on skirt
- Transom protector for raising the tender



INTERIOR

- Fruitwood Apli joinery or Alpi Fruitwood / lacquered white - Saloon / Galley (optional)
- White ceruse oak laminate flooring
- Bulkheads upholstered in vinyl fabric
- Fabric upholstery in the saloon
- Marine mattresses in the cabins

COMPANIONWAY

Headroom: 1,99 m / 6'6"

- Wooden companionway with cold-moulded 3 steps
- 2 Leather covered stainless steel handrails

PORT SALOON

Headroom: 1,98 m / 6'6"

- U shaped saloon bench
- Saloon table in 1 piece, Varnished wood top with inlay, Aluminium legs.
- 1 central unit with folding bench seat - Stowage - Bar
- Shelves and stowage along the hull, Storage under bench seats
- 1 Hull porthole with curtain
- 1 Fixed deck house side window with concertina blind
- 1 Fixed wrap-around window to cockpit + Blind
- 1 flush deck hatch with blind / Mosquito net

CHART TABLE

- Control console with flap - oddments locker - Storage - Moulded wood fiddle
- Navigator's seat with (15°) tilting cushion to compensate for heel
- Electrics panel
- Navigation instrument panel (without instruments)
- Radio CD player / Stereo MP3 - 2 Loud speakers
- Battery switch panel + Breaker panel

GALLEY - STARBOARD

Headroom: 1,97 m / 6'6"

- Lengthways kitchen
- Synthetic resin worktop Grey
- 1 Sink with 2 rectangular bowls, in Grey synthetic resin
- 1 Valve - Faucet
- 1 Gas cooker 2 burners, Stainless steel oven on mountings
- 1 Fridge 200 l, ice-cube tray, front and top-opening
- 1 Cooler 100 l, top opening
- Cupboards - Drawers - equipped lockers
- 1 Hull porthole with curtain
- 1 Fixed deck house side window with concertina blind
- 1 Fixed wrap-around window to cockpit + Blinds
- 1 flush deck hatch with blind / Mosquito net

FORWARD CABIN

Headroom: 1,94 m / 6'4"

- Central double bed (2,03 m x 1,21 m - 1,70 m / 6'8" x 4' - 5'7") - Slatted bed base
- Wardrobe, Cupboard, Shoe cabinet
- Leather-topped dressing table with removable seat
- Mirrors
- 2 Hull portholes with curtain
- 2 Opening deck hatches with blind / Mosquito nets

FORE WASHROOM

Separate shower, to port

Headroom: 1,93 m / 6'4"

- Private access via glazed door
- Mirror - Cupboard
- Shower - Faucet
- 1 flush deck hatch with blind / Mosquito net

Separate WC. to starboard

Headroom: 1,94 m / 6'4"

- Manual marine toilet
- Washbasin - Synthetic resin worktop - Faucet
- Mirror
- Toilet accessories
- Cupboard - Cubby hole locker
- 1 flush deck hatch with blind / Mosquito net

CABINS - PORT AND STARBOARD

Headroom: 1,97 m / 6'6"

2 Cabins each with:

- Sliding entrance door
- Double bed (2,00 m x 1,00 m - 1,56 m / 6'7" x 3'3" - 5'1") - Slatted bed base
- Hanging locker - Shelving - Drawers
- Mirror
- 1 Hull porthole with curtain
- 1 Opening deck hatch with blind / Mosquito net

HEADS VERSION - PORT AND STARBOARD

Headroom: 1,94 m / 6'4"

2 Each washroom containing:

- Private entrance through cabin
- Separate moulded shower, Faucet
- Manual marine toilet
- Washbasin - Synthetic resin worktop - Faucet
- Mirror
- Toilet accessories
- Cupboard and cubby hole
- 1 Opening deck hatch with blind / Mosquito net

OCCASIONAL CABIN (OPTIONAL) - In place of the sail locker (Port side)

Headroom: 1,18 m / 3'10"

Access through the cockpit locker

- Solid wood sliding ladder
- Marine mattress
- 1 Opening porthole
- 1 Opening hatch

ENGINE

- Engine Yanmar Diesel 75 hp / 75 HP Sail Drive or POD 120 Dock & Go or POD 120 Dock & Go
- Engine control - Starting - Control panel in cockpit
- Engine compartment: Foam soundproofing - Ventilation: 1 air intake and 1 pressured air outlet
- 1 Alternator 12 V / 125 Ah (Dock & Go: 1 Alternator 12 V / 120 Ah)
- 1 Rotomoulded diesel tank (415 l / 110 US Gal in the saloon) - Electronic gauge - Low level alarm - 1 Deck filler
- Filters: Sea water - Diesel - Decanter
- Fixed three blades propeller
- Engine access via companionway and machinery space (opening with gas piston)

ELECTRICITY

- 12 V circuit - 220 V circuit
- 2 service batteries (2x140 Ah) - 1 Engine battery (110 Ah)
- 1 40 Ah Battery charger - 1 220V shore power - 1 Power distributor
- Electrical panel (12 V / 220 V) (Circuit breakers - Voltmeter - Water gauge - Fuel gauge - Battery warning - Fuel warning)
- Sockets 220V
- Interior lighting: Halogen ceiling lights, Reading lights
- Outside lighting: 1 Forward and aft navigation lights - 1 Engine navigation light / Spreader light forward of mast - 1 Anchor light on masthead - 1 Deck light
- Wire runs for options cables

PLUMBING

- 3 Rotomoulded freshwater tanks (3 x 200 l / 3 x 53 US Gal) - Saloon / Side cabins - Separate fillers - Tank selection with ¼ by-pass valves
- Pressurised electric water pump - Expansion tank - Inline filter
- 40 L / 11 US Gal Electric water heater (Operation off engine or on 220 V electrical system)
- 1 80 L / 21 US Gal rigid black water holding tank in port head compartment
- Electrical shower drain pumps
- 2 Electric bilge pumps - 1 Manual bilge pump
- 1 Electric ice box drain pump

GAS

- Gas bottle box in the cockpit (1 or 2 bottles, according to model)
- Regulator and safety tap



BENETEAU

Sense (55')

General Equipment list - Europe

TRIM LEVEL

	ESSENTIAL	EXCLUSIVE
<ul style="list-style-type: none"> • 1 Port electric coachroof winch (H50.2 STECH) • Releasable forestay chainplate • Stainless steel beading for fenders in cockpit locker • 4 Opening ports in galley and saloon windows • Hifi: Fusion + Interior loudspeakers & Waterproof exterior speakers • 12/220 V, 2 kVA converter • 2 USB sockets at the chart table to recharge mobile devices • 2 service batteries (2 x 140A, 12V) + 40 amperes Additional battery charger • Gel batteries • Storage space(s) under the floor • LED: <ul style="list-style-type: none"> - Interior lighting - Navigation lights 	<ul style="list-style-type: none"> ■ ■ ■ ■ ■ ■ ■ ■ ■ ■ ■ ■ 	<ul style="list-style-type: none"> ■ ■ ■ ■ ■ ■ ■ ■ ■ ■ ■ ■
<ul style="list-style-type: none"> • Cockpit sole natural solid wood • Motorised glazed folding companionway door in cockpit floor + 2 Remote controls • Pump for deck washing • Textile storage with 2 steering consoles • Upgrade - Bose Acoustimass 3 speakers in saloon • Galley: <ul style="list-style-type: none"> - "Luxe" 3 burners hob, stainless steel oven and grill - 12 V Freezer compartment in 100 L Top-opening icebox (Freezer) • 3 Electric toilet + Reserve • LED interior lights (Indirect) • Closet lighting 		<ul style="list-style-type: none"> ■ ■ ■ ■ ■ ■ ■ ■ ■ ■ ■

PACKS

ELECTRONIC B&G PACK

A Pack

- Helm consoles to port and starboard:
 - 1 T41 Graphic B&G display (Loch, Speedometer, Depth sounder, Windvane anemometer)

B Pack

- Helm consoles to port and starboard:
 - Multifunction touchscreen B&G Zeus 9" wide (GPS, Chart plotter, Chart reader - Cartography Navionics Silver included)
- Wifi interface
- PC interface

DOCK & GO VERSION

- YANMAR Diesel Dock & Go POD 60 engine
- Swivel Saildrive base
- Joystick
- Vessel Management Unit (VMU)
- Bow thruster
- Auto pilot

OTHER OPTIONS

NAVIGATION ELECTRONICS: B&G

- AC42 autopilot + Control at steering station
- WR 10 Wireless autopilot remote control
- 4G Radar
- AIS 400 (Transmitter / Receiver)
- Port cockpit: B&G H50 VHF, function AIS receiver + H50 cockpit handset
- Chart table: Fixed B&G RS90 VHF, function AIS receiver
- Chart table: Multifunction Zeus 12" wide screen
- Forward Scan Sensor (underwater vision Forward)

RIGGING - SAIL

- Anodised furling mast with mylar Taffetas main and genoa
- Asymmetrical spinnaker rigging + Code 0 Rigging
- Self-tacking jib hardware
- Hydranet sail for classic mast (In place of standard)
- Hydranet self-tacking jib (replacing genoa)
- Hydranet self-tacking staysail with manual furling + Fixed forestay
- Laminated Mylar Taffetas (code0) with furling drum
- Asymmetrical spinnaker
- Releasable forestay chainplate
- Backstays with bottlescrews (Adjustable)*
- Genoa sheet track leads adjustable from the cockpit
- Flag halyards

* Except on mast with in-mast furling

WINCHES

- Electric genoa sheet winches H60.2STCEH
- Starboard electric coachroof winch H46.2STCEH
- Rewind rope handling winch

HULL - DECK - COCKPIT

- Blue-grey hull - Pearl white livery
- Grey "Perle" hull - Matte black hull decoration
- Metallic hull paint
- Solid wood slatted catwalks
- Starboard wood cockpit table with electrical up/down system - White PVC protective cover
- Wood cockpit table port side, plate and removable seat
- Graphite Coachroof sprayhood
- Graphite Cockpit Bimini
- White PVC steering wheels and console covers
- Luxe coachroof sprayhood, Cadet Grey
- Cockpit bimini Luxe, Cadet Grey
- Complete cockpit closing Luxe, Cadet Grey
- Covers pack Luxe (Table + Steering consoles), Cadet Grey
- Natte Stone + Quadri Grey outside upholstery + Backrests to helm
- High comfort outside upholstery
- Bow thruster
- 3 retractable blades propeller
- 2nd arch with davits and instrument base
- 2nd arch with davits, solar panels + wind turbines
- White composite steering wheels
- Moorings lines, Mooring, Fenders
- Windlass control in cockpit with chain counter
- Shore freshwater supply
- Pump for deck washing
- Underwater projector
- Windex Windvane

INTERIOR EQUIPMENT

- Interior woodwork: Alpi matt light oak
- Upholstery: Fabrics ou Ultraleather
- Ivoire Complete carpet
- Grey upholstery padding in all cabins or Taupe
- Leather-covered chart table and console unit in the saloon
- White-lacquered doors - Saloon / Galley
- Luxe folding saloon table on electric leg with up/down control
- TV LED 23" folding + DVD and MP3 player in master cabin
- TV LED 32" folding + Player Fusion (Bluetooth, USB, Dvd, MP3) in the saloon
- Double berth in saloon
- All-electric galley:
 - 220V Microwave oven
 - 220 V Dishwasher - 6 persons
 - Extractor hood
 - Sea water/fresh water foot pump
 - Freshwater purifier
- 220V Ice maker
- Washer dryer 220 V
- Safe
- Electrically-operated saloon window blinds
- Removable blind entrance door
- Additional holding tank 80 l / 21 US Gal - (For manual WC)
- Removable extra table
- Extra water tank (330 litre / 87 US Gal)
- Additional diesel tank (415 l / 110 US Gal in the saloon)
- 7 kVA 220 V / 50 Hz Generator
- Water maker 60 l/h / 16 US Gal/hour 12/220V
- Water system heating
- Chilled water air-conditioning unit 220V

OTHER LAYOUT VERSIONS AVAILABLE

OCCASIONAL CABIN

Port aft

- Access through the cockpit locker - Gas cylinder opening
- 1 Single berth
- 1 Opening porthole
- 1 hinged plexiglass panel in the cockpit side