

3 cabins layout

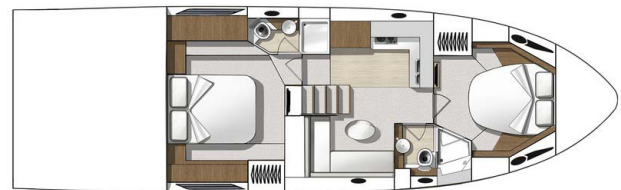

2 cabins layout

GENERAL SPECIFICATIONS

• L.O.A*:	15,73 m	51'7"
• Hull length:	14,09 m	46'3"
• Overall width:	4,37 m	14'4"
• Beam:	4,27 m	14'0"
• Light displacement (EC):	14 990 kg	33,038 lbs
• Air draught:	5,86 m	19'3"
• Draught (max):	0,90 m	2'11"
• Fuel capacity:	2 x 650 L	2 x 172 US Gal
• Freshwater capacity:	2 x 320 L	2 x 85 US Gal
• Maximum engine power:	2 x 320 Kw - 2 x 435 HP	2 x 435 HP
• Max engine certification:	2 x 320 Kw - 2 x 435 HP	2 x 435 HP

* (with aft swimming platform)

ARCHITECTS / DESIGNERS

- Naval Architect: Beneteau Power Boats
- Interior design: P. Andreani

CE CERTIFICATION

- Category B - 14 people
- Category C - 16 people
- Category D - 16 people



STANDARD EQUIPMENT

CONSTRUCTION

HULL

White hull

Composition:

- Sandwich (Polyester resin - Glass fiber - Balsa core)
- Hull counter moulding laminated in monolithic (Polyester resin - Glass fiber)
- 8 opening portholes (fitted with curtains)

DECK

Composition:

- Sandwich (Polyester resin - Glass fiber - Balsa core)
- Deck counter moulding laminated in monolithic (Polyester resin - Glass fiber)

DECK EQUIPMENT

- Polyester radar support
- Navigation lights

MOORING LINES - MOORING

- Swivel bow fitting with anchor securing system
- 2000 W Electric windlass (with remote control)
- 2 Forward cleats, 2 central and 4 aft in stainless steel

SAFETY ON DECK

- Half open pulpit in stainless steel with guardrail and hand rail
- 2 Stainless steel handrails on access to side decks steps
- 2 Stainless steel handrails on forward sun deck
- 1 Grab rail behind the cockpit benchseat

DECK

- Forward sun deck: 2,30 x 2,00 m / 7'7" x 6'7"
- Forward peak decked in plain solid wood

COCKPIT

- Natural solid wood cockpit
- Cockpit unit with sink, grill stand and space for refrigerator (options), storage
- 6-seater outside benchseat (convertible into sunbed with optional table)
- Space for 2 life rafts for 10 persons
- Cockpit shower hose with hot water mixer tap / Cold water
- Cupholders & stowage
- Gate access (Port side)
- Solid wood bathing platform
- Stainless steel, removable swim ladder, Stowage in the garage housing the tender (Access beneath the benchseat)
- Garage for inflatable 2,85m (9'4") tender and outboard engine, in position
- Electrically-opened, using 2 electric struts
- Starboard access to engine room
- Direct lighting LED

FLYBRIDGE

- 6 persons convertible saloon into sun deck
- Chaise longue and bench seats
- Pilot and copilot seat
- Second steering station
- Access to Fly-deck by outside galley furniture built-in ladder

INTERIOR

- in the choice:
 - Brown oak laminated floors + Woodwork Alpi Walnut (standard)
 - Parquet type laminated floors + Woodwork Alpi Mahogany
- Accent Grey Taupe Cushions

WHEELHOUSE

Headroom: 1,97 m / 6'6"

- 3-panel sliding window door with curtains (mirror tinted)
- Lights (spotlights and indirect lights)

STEERING STATION

- Transparent windscreen, black-lacquered uprights
- Mirror tinted side windows with blinds
- 2 Windscreen wipers with washers
- Demisting system
- Pilot and copilot bench with Bolster function, Anthracite grey PVC upholstery
- Instrument panel painted with silk-finish chestnut paint
- Compass, Revolution counter, Tiller angle indicator
- Engine function indicators on 7" VOLVO digital display
- Interior socket 12 V for mobile phone
- Valet tray

SALOON

- Bench seat 6 persons and wooden table matching the woodwork, Electric table pedestal
- Bar with panoramic view
- Storage space in bar unit and under bench seats
- Location for 36" LED television, DVD player and Bose speakers (Options)
- Ivoire Carpet (standard) or Taupe under wheelhouse table
- 220 V socket

LOWER SALOON

Headroom: 1,98 m / 6'6"

- Bench seat - 4 people
- Storage cupboards
- Opening hull porthole in saloon
- Ivoire Carpet
- 220 V socket

OR: 3RD CABIN

- 2 Single berths
- Marine mattress
- Hanging locker + Storage cupboards
- Ivoire Carpet



GALLEY

Headroom: 1,98 m / 6'6"

Galley-type layout:

- Optimum storage space
- Stainless steel sink with mixer tap
- Ceramic hob (2 burners)
- White corian type worktop
- 24 l Micro-wave oven
- 270 l Fridge Freezer
- Cutlery storage
- Bin with fitted twin bucket
- Opening hull porthole
- White-lacquered (standard) or optional Taupe or Cream-lacquered units
- 2 220 V Sockets

OWNER'S CABIN (AFT)

Headroom: 2,15 m - 1,60 m / 7'1" - 5'3"

- Full beam stateroom
- Double berth (2,00 x 1,70 m / 6'7" x 5'7")
- Strut-mounted bed
- Marine mattress
- Padded headboard
- Wardrobes, Hanger closets, Storage
- Spotlights and LED reading lights
- 220 V socket
- 2 Panoramic opening porthole-fitted portlights with blinds
- Space for LED 32" screen television (+ TV in option)
- Meridian couch to port or storage cupboard (option)
- Mirror
- Ivoire Carpet

OWNER'S HEAD COMPARTMENT

Headroom: 2,30 m / 7'7"

- Vacuflush electric toilet + Shared rigid tank (150 L / 40 US Gal)
- Shower separated with 3 swing doors
- Basin with mixer tap
- Mirror and storage space
- Automatic shower water drainage
- 220 V socket

VIP CABIN (FORWARD)

Headroom: 1,95 m / 6'5"

- 1 Double berth (2,00 x 1,60 m / 6'7" x 5'3")
- Marine mattress
- 2 Panoramic opening porthole-fitted portlights with blinds
- Closets and cubbyholes
- Ivoire Carpet
- 2 Drawers under the bed
- Strut-mounted bed
- 220 V socket
- Spotlights and LED reading lights
- Mirror

VIP HEAD COMPARTMENT

Headroom: 1,98 m / 6'6"

- Vacuflush electric toilet + Shared rigid tank (150 L / 40 US Gal)
- Shower separated with 2 swing doors
- Basin with mixer tap
- Mirror and storage space
- Automatic shower water drainage
- 220 V socket

ENGINE

Propulsion IPS:

- Volvo 2 x D6 IPS 600 - 2 x 435 HP/HP Diesel (2 x 320 Kw) EVC-E
- Fuel filter with decanter
- Sea water filter
- Air intakes on the deck for engine compartment cooling
- Hot air extraction forced by electric ventilators
- Engine room foam soundproofed
- Fire extinguishing system activated from the steering station
- Stainless steel fuel filler
- 2 x 650 L / 172 US Gal Roto moulded fuel tanks

Steering system:

- Hydraulic steering
- 2 Drives with counter rotative propellers

Softs Volvo:

- Trip computer
- Cruise control
- Single lever
- Low speed

ELECTRICITY

- 8 Batteries 12 V (4 Engine batteries 50 Ah + 4 Service batteries 140 Ah)
- 3 Bilge pumps: 2 Electric pumps - 1 Manual pump
- 2 Extinguishers
- Inverter 12 V / 24 V
- Power distributor
- Battery charger 24 V 60 Ah
- Interior sockets 220 V
- 220 V shore power
- Spotlights and LED reading lights

PLUMBING

- 2 x 320 L / 2 x 85 US Gal Roto moulded water tanks
- Stainless steel water filler
- Water pump for pressurising hot/cold water system
- 60 L / 16 US Gal water heater working off engine exchanger and 220 V

TRIM LEVEL

	BLACK EDITION
• Launching ramp + Winch	■
• TV LED 36" + Fusion 700 + Bose speakers in the wheelhouse saloon	■
• SIMRAD NSS 12" Multifunction screen + Depth sounder	■
• SIMRAD VHF + AIS transponder	■
• 42 L Cockpit refrigerator	■
• Forward sun mattress + Protective cover + Adjustable backrest	■
• Solid wood cockpit table with electric leg	■
• Exterior upholstery: Black Edition - Padded Vogue Cashew, Carbon Black & Vogue Onyx	■
• Exterior decoration: Black Edition	■

OPTIONS

PACKS

ELECTRONIC PACK

- Fitted Auto pilot
- Broadband 4G Radar
- Wifi connection module for ipad

OTHER OPTIONS

INTERIOR / ONBOARD COMFORT

- Mediterranean Air conditioning 43 000 BTU - 220V, (Wheelhouse 16 000 BTU (under pilot bench), Aft cabin 9 000 BTU, Forward cabin 9 000 BTU, 3rd cabin or Lower saloon 9 000 BTU)
- Tropical Air conditioning 51 000 BTU - 220 V (Wheelhouse 24 000 BTU, 9 000 BTU in each cabin)
- Forced air heating fuel (in wheelhouse, Cabins, Lower saloon)
- Dishwasher - seating 6 persons
- TV LED 32" + Player DVD / MP3 in master cabin (Antenna not included)
- TV LED 23" + DVD/MP3 player in the VIP cabin
- CD player, MP3, USB , IPOD, in the VIP cabin
- Stowage unit in owner cabin
- Washer dryer - 220 V / 50 Hz
- Crème lacquered furniture (replacing white lacquered)
- Taupe lacquered furniture
- PVC Mediterraneo Old White saloon cushions
- Mondo Moka Saloon upholstery
- Mondo Beige Saloon upholstery
- Ultraleather Saloon upholstery
- Leather Saloon upholstery
- Taupe carpet (2 and 3-cabin layout)
- Ivory carpet in the wheelhouse
- Taupe carpet in the wheelhouse
- Gallery worktop in Corian Taupe

EXTERIOR

- Complete mooring kit
- Bow thruster station dual
- 7 kVA Generator / 50 Hz ONAN (220 V)
- 11 kVA Generator / 50 Hz ONAN (220 V)
- Additional SIMRAD NSS 12" evo2 display in wheelhouse
- Additional Joystick in the cockpit
- Underwater light
- Hydraulic swim platform
- Integrated hydraulic gangway
- Bose speakers (Cockpit + Fly)
- Exterior upholstery PVC Diamante Ivory piping
- Exterior upholstery: Diamante Moonlight
- Sunworker white exterior windscreen curtains
- Electric cockpit grill - 220 V
- Cockpit ice maker
- Fresh water deck washing pump
- Fresh water shore supply
- Burgundy and white hull
- Grey blue and white hull
- Hull covering
- Bimini of Flybridge Silver
- Deck spotlight on flybridge



America/Export: Please note that electric power and appliances may be different and/ or not offered on standard or on option. They would be adapted locally by your dealer.